

CF Consoles

carrying console, supported

2 ton to 4 ton Console

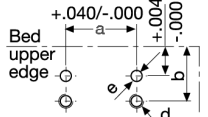

Socket head screws DIN 912
M16 x110, 8.8
Torque to 90 ft. lbs.
Roll pin DIN 1481 Ø16 x 40

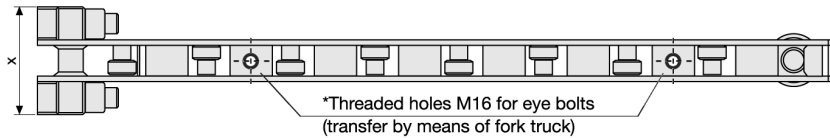

6 ton to 10 ton Console

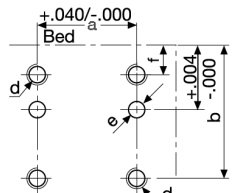

Socket head screws DIN 912
M16 x 50 und M16 x 110
Torque to 90 ft. lbs.
Roll pin DIN 1481 Ø16 x 50

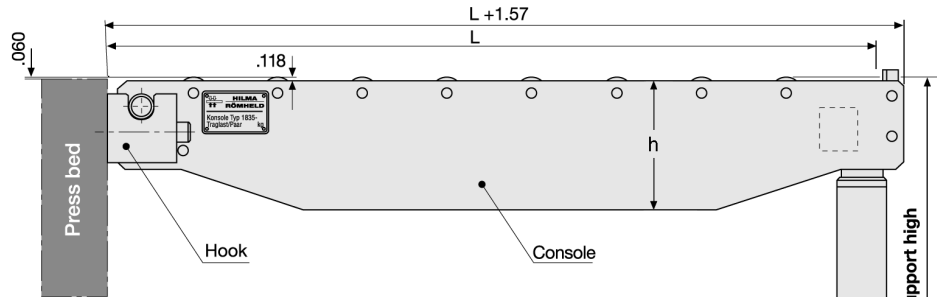

When ordering, please specify the exact height of support

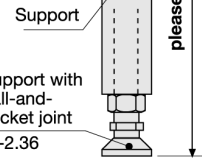

16 ton to 25 ton Console

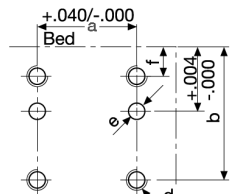

Socket head screws DIN 912
M24 x 80 und M24 x 160
Torque to 184 ft. lbs.
Roll pin DIN 1481 Ø20 x 100

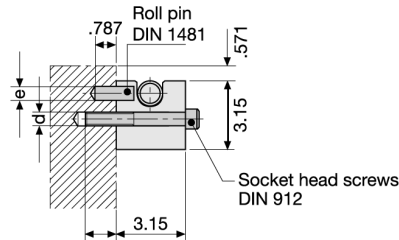

Example of ordering: HCR-CF-2/1000 SH=39"
console 39" long
max. 4,500 lbs.
height of support 39"

Part Number for 1 pair	Support Wt. (lbs)	Length (in)	Dimensions (in)							Weight/Pair (lbs)	
			a	b	c	d*	e*	f	h		x
HCR-CF-2/1000	4,500	39	3.39	2.36	1.18	M16	Ø16	-	5.91	4.92	132
HCR-CF-2/1250	4,500	49	3.39	2.36	1.18	M16	Ø16	-	7.09	4.92	176
HCR-CF-2/1600	4,500	63	3.39	2.36	1.18	M16	Ø16	-	7.87	4.92	221
* HCR-CF-4/1000	9,000	39	3.39	2.36	1.18	M16	Ø16	-	7.87	4.92	154
* HCR-CF-4/1250	9,000	49	3.39	2.36	1.18	M16	Ø16	-	7.87	4.92	187
HCR-CF-4/1600	9,000	63	3.39	2.36	1.18	M16	Ø16	-	8.86	4.92	243
HCR-CF-6/1000	13,500	39	3.58	4.13	1.77	M16	Ø16	.79	7.87	4.92	165
HCR-CF-6/1250	13,500	49	3.58	4.13	1.77	M16	Ø16	.79	8.66	4.92	198
* HCR-CF-6/1600	13,500	63	3.58	4.13	1.77	M16	Ø16	.79	9.45	4.92	265
HCR-CF-6/2000	13,500	79	3.58	4.13	1.77	M16	Ø16	.79	10.63	4.92	375
HCR-CF-10/1250	22,500	49	3.58	4.13	1.77	M16	Ø16	.79	9.85	4.92	221
HCR-CF-10/1600	22,500	63	3.58	4.13	1.77	M16	Ø16	.79	11.02	4.92	309
HCR-CF-10/2000	22,500	79	3.58	4.13	1.77	M16	Ø16	.79	12.60	4.92	397
HCR-CF-16/1600	36,000	63	6.30	5.71	2.95	M24	Ø20	1.18	9.06	8.27	529
HCR-CF-16/2000	36,000	79	6.30	5.71	2.95	M24	Ø20	1.18	10.24	8.27	728
HCR-CF-16/2500	36,000	98	6.30	5.71	2.95	M24	Ø20	1.18	11.02	8.27	1058
HCR-CF-25/2500	56,250	98	6.30	5.71	2.95	M24	Ø20	1.18	14.17	8.27	1191

* Denotes metric fasteners

* Short Delivery

4 hooks and 2 supports are supplied with the consoles.

1 additional set of hooks (4 ea.)

HCR-7.1835.0007 (4 ton), HCR-7.1835.0021 (10 ton), HCR-7.1835.0022 (25 ton)